



SALIVA SCREEN TEST

DS08 Plus

PROCEDURE CARD

V2

Bring test kit to room temperature (15-30°C) before use.

The oral fluid specimen should be collected using the collector provided with the kit. No other collection devices should be used with this drug test.

Sponge Collector

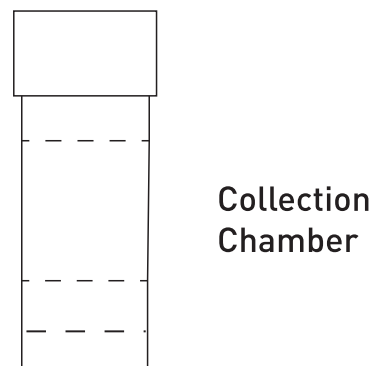
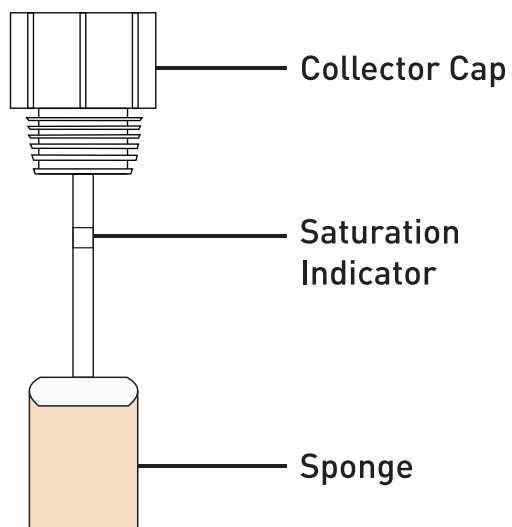

Donors should avoid placing anything (including food, drink, gum and tobacco products) in their mouth for at least 10 minutes prior to specimen collection.

STEP 1

Unscrew the collector cap to pull out the sponge collector from the collection chamber.



STEP 2

Insert the sponge end of the collector into the mouth horizontally. Actively swab the inside of the mouth and tongue to collect oral fluid (for typically around 3 minutes) until the sponge is soft and fully saturated.

The saturation indicator will turn from colourless to pink. No hard spots should be felt on the sponge when saturated.

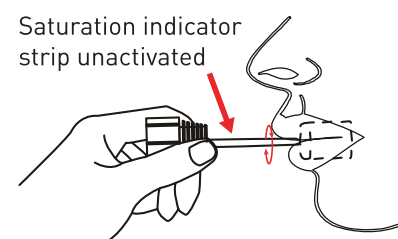

DO NOT bite, suck or chew on the sponge.

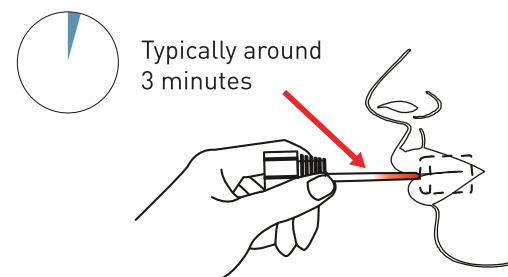

STEP 3

Return the sponge collector into the collection chamber. Press the sponge collector downwards and seal the test by screwing the collector cap on tightly.

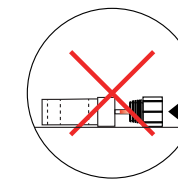
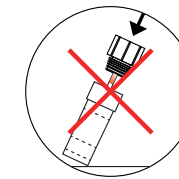
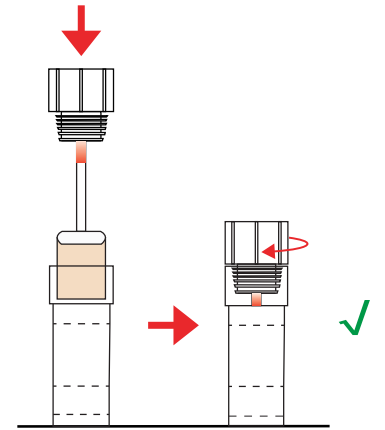

NOTE: Put the sponge into the cup and press it to collect oral liquid. Keep the cup on a flat and stable surface and press it vertically downward.

STEP 4

Peel off the label to read the test results.

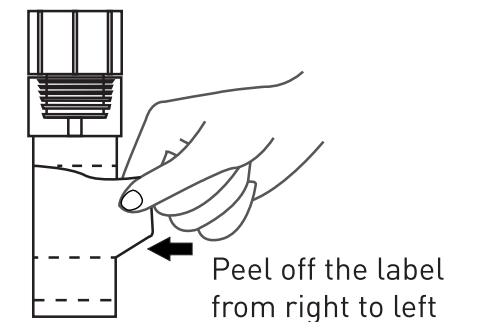

Read saliva alcohol pad at **3 minutes**.



Read test strip results at **10 minutes**.

